



# pool health kit

## owner's manual



**ZODIAC**

## What's Included?



1 x TWIST



1 x Vial  
(25 Twist & Dose  
3-in-1 test strips)

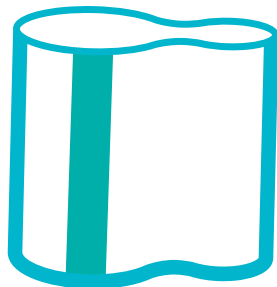

1 x Measuring Jug  
for Zodiac Sparkle  
Purifier Chlorine  
(green level  
measuring sticker)



1 x Scoop for  
Zodiac Sparkle  
Purifier Chlorine  
(green sticker)

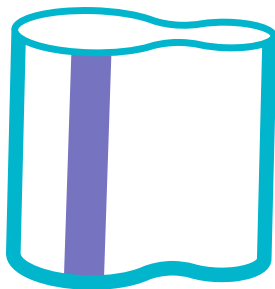

1 x Measuring Jug  
for the balance  
chemicals: (1) Zodiac  
Alkalinity Up, (2)  
Zodiac pH Up, (3)  
Zodiac pH Down  
(three purple level  
measuring stickers).



1 x Scoop for the  
balance chemicals:  
(1) Zodiac Alkalinity Up,  
(2) Zodiac pH Up,  
(3) Zodiac pH Down  
(purple sticker)

## IMPORTANT

**READ THIS MANUAL IN ITS ENTIRETY BEFORE USING TWIST & DOSE.**

*Purchaser assumes all risks of use and handling where the product is not used in accordance with directions given.*

# 1

## Choose Your Pool Size

The window panel side of the Twist & Dose box indicates which pool size kit you purchased: (S) Small Size Pool, (M) Medium Size Pool, or (L) Large Size Pool

Turn the yellow dial underneath the TWIST to select your specific pool size.

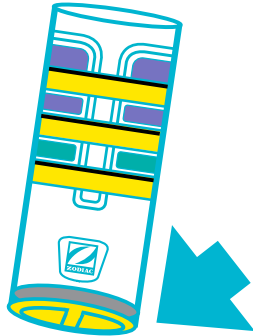

Pool size in litres (L) is shown in the window on the back of the TWIST.



For your pool size, choose between:

<b>S</b>	20,000 L	25,000 L	30,000 L
<b>M</b>	40,000 L	50,000 L	60,000 L
<b>L</b>	70,000 L	80,000 L	90,000 L

If your pool is inbetween sizes, choose the next larger size on the TWIST.

### note

*You only need to dial in your pool size the very first time you use the TWIST.*

# 2 TWIST to Test Water

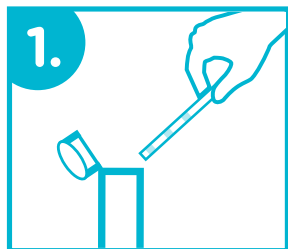

1.

Remove one test strip from the vial and recap the vial.

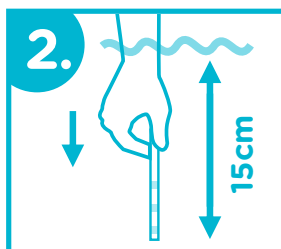

2.

Immerse strip for 2 seconds to a depth of 15 cm and remove with pads facing up.

## CAUTION

*Check the use by date info on the test strip vial and discard test strips if they are expired.*

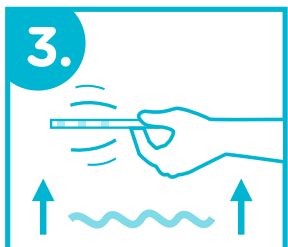

3.

Shake the strip once to remove excess water.

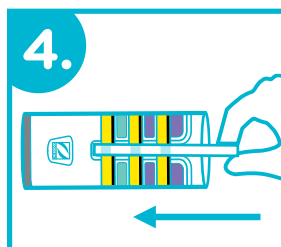

4.

Immediately place strip horizontally in the TWIST strip housing.

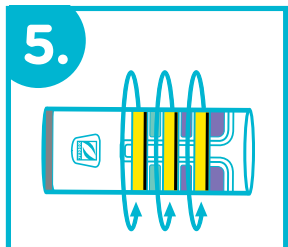

5.

Twist each of the yellow rings to match the colour of the test strip pad with the colour for Total Alkalinity, pH, and Free Chlorine.

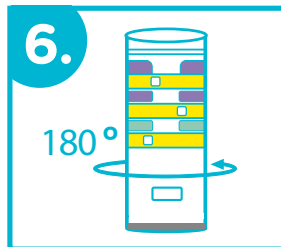

6.

Turn the TWIST device around to see recommendations for Total Alkalinity, pH, and Free Chlorine.

## hint

*Do not match colours with sunglasses on.*

# 3

## Read Recommendations

### TOP RING: Total Alkalinity

Turn the TWIST around to read recommendations.

The window in the top yellow ring shows the recommendation for regulating the Total Alkalinity of your pool water using one of two specific Zodiac TWIST & DOSE chemicals, either: Alkalinity Up or pH Down.

**OK**

Your pool is balanced. No need to add chemicals.

**1kg**

Recommended dose of Alkalinity Up or pH Down chemical, shown in kg or g.



Visit your nearest Zodiac pool shop for advice. The core parameter is extremely out of normal range.

See STEP 4 for instructions on how to dose your pool.

#### **note**

*The recommended doses for Total Alkalinity are calculated with safety in mind to avoid overdosing the pool. Having the correct Total Alkalinity levels in your pool will prevent extreme pH fluctuation in the water and make it easier to adjust.*

## MIDDLE RING: pH Range

Turn the TWIST around to read recommendations.

The window in the middle yellow ring shows the recommendation for regulating the pH of your pool water using one of two specific Zodiac TWIST & DOSE chemicals, either: pH Up or pH Down.



Your pool is balanced. No need to add chemicals.



Recommended dose of pH Up or pH Down chemical, shown in kg or g.



Visit your nearest Zodiac pool shop for advice. The core parameter is extremely out of normal range.

See STEP 4 for instructions on how to dose your pool.

### note

*For chlorine to be most efficient, and to maximize bathers' comfort, it is important to maintain pH levels between 7.2 and 7.8.*

## BOTTOM RING: Sparkle Purifier

Turn the TWIST around to read recommendations.

The window in the bottom yellow ring shows the recommendation for adding Zodiac TWIST & DOSE Sparkle Purifier.



Your pool is protected. No need to add chemicals.



Recommended dose of Sparkle Purifier chemical, shown in kg or g.



Visit your nearest Zodiac pool shop for advice. The core parameter is extremely out of normal range.

See STEP 4 for instructions on how to dose your pool.

### note

*Free chlorine consumption in your pool may vary depending on the bather load and the weather conditions. The TWIST will help you achieve ideal chlorine levels to protect you and your pool water.*

*For daily dosage recommendations, please refer to the product label guidelines.*

*Weekly shock treatments are recommended.*

4

## DOSE Your Pool

It's easy to recognize the four Zodiac TWIST & DOSE chemicals by the TWIST & DOSE sticker on the bucket.



Use only Zodiac TWIST & DOSE chemicals: Alkalinity Up, pH Down, pH Up, and Sparkle Purifier.



## TOP RING: Total Alkalinity



Use the purple scoop and measuring jug to dose the recommended amount of Zodiac TWIST & DOSE Alkalinity Up or pH Down.

Dissolve dosage in a bucket of pool water before applying the solution evenly around the edges of the pool. Run your pump for at least two hours following treatment.

Rinse the scoop and jug thoroughly after each use.

Repeat daily the steps to test and dose your pool with Zodiac TWIST & DOSE Alkalinity Up or pH Down until the top ring of the TWIST shows **OK**.

Using pH Down and Alkalinity Up also affects your pool's pH levels. After each Total Alkalinity treatment, please re-test your pH levels.

### CAUTION

*Do not mix chemicals. Do not inhale fumes. Wash hands with plenty of water if in direct contact with chemicals.*

## MIDDLE RING: pH Range



Use the purple scoop and measuring jug to dose the recommended amount of Zodiac TWIST & DOSE pH Up or pH Down.

Dissolve dosage in a bucket of pool water before applying the solution evenly around the edges of the pool. Run your pump for at least two hours following treatment.

Rinse the scoop and jug thoroughly after each use.

Repeat daily the steps to test and dose your pool with additional pH Down or pH Up until the middle ring of the TWIST shows **OK**.

### CAUTION

*Do not mix chemicals. Do not inhale fumes. Wash hands with plenty of water if in direct contact with chemicals.*

## BOTTOM RING: Sparkle Purifier



Use the green scoop and measuring jug to dose the recommended amount of Zodiac TWIST & DOSE Sparkle Purifier.

Make sure your pump is on before dosing your pool with chlorine. Dissolve dosage in a bucket of pool water and apply the solution evenly around the edges of the pool. Run your pump for at least two hours following treatment.

Rinse the scoop and jug thoroughly after each use.

### CAUTION

*Do not mix chemicals. Do not inhale fumes. Wash hands with plenty of water if in direct contact with chemicals.*

## helpful hints

- Always allow at least two hours between each Zodiac TWIST & DOSE chemical dosage.
- If the pool does not return to the ideal conditions after 3 days of treatment, consult your Zodiac pool shop.
- Shock treatments are recommended following heavy rain, hot weather, and heavy bather loads.
- In addition to TWIST & DOSE chemical treatments, Zodiac recommends you have your pool water tested by your local pool shop on a monthly basis for cyanuric acid, calcium hardness and phosphate concentrations.
- Daily testing is recommended during warm weather and heavy usage of your pool.
- Please contact your pool store if you observe changes in water colour and clarity.